

Wall Mounting Storage Cabinet and Wall Panels

Instruction for the following:

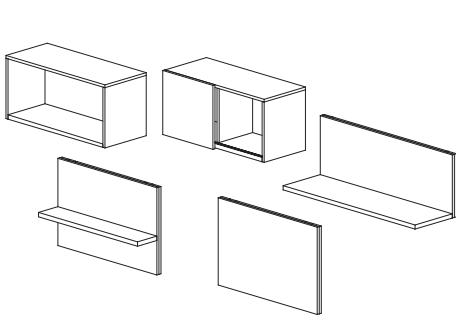

Wall Mount Cabinet with or without Wall Panels

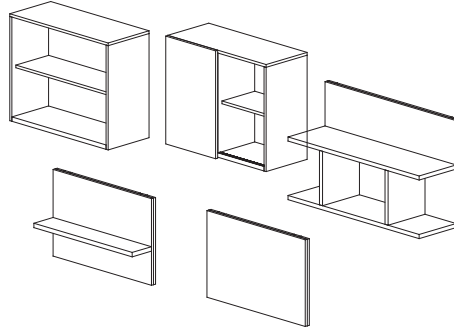

Double Height Wall Mount Cabinet with or without Wall Panels

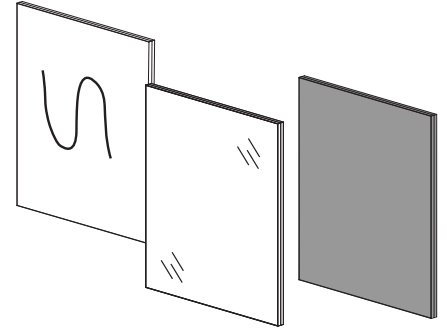

Wall Mount Panel without Cabinets

Recommended Tools

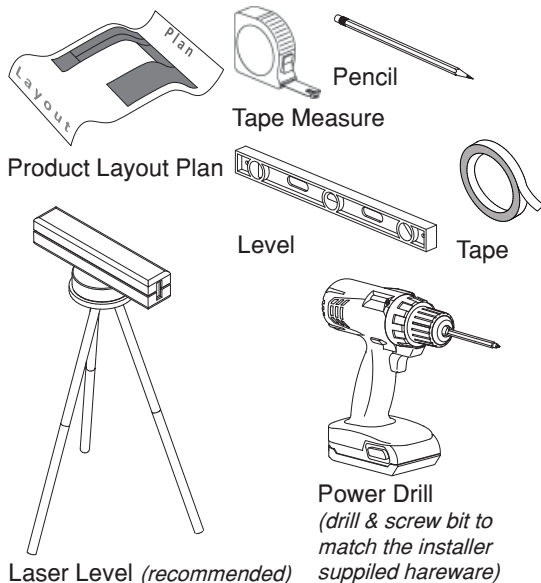

Hardware Provided

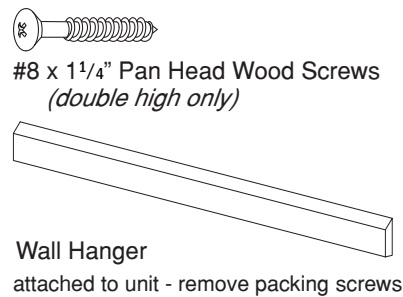

Needed Hardware

Hardware to attach wall hanger to the building wall is supplied by installation company

Product Weight Information

Single High Storage Cabinet

96" wide / 184 lbs	60" wide / 129 lbs
90" wide / 173 lbs	54" wide / 115 lbs
84" wide / 163 lbs	48" wide / 103 lbs
78" wide / 149 lbs	42" wide / 93 lbs
72" wide / 139 lbs	36" wide / 75 lbs
66" wide / 129 lbs	30" wide / 65 lbs

(weights are approximate for an empty cabinets with wood doors)

Double High Storage Cabinet

96" wide / 284 lbs	60" wide / 190 lbs
90" wide / 269 lbs	54" wide / 173 lbs
84" wide / 253 lbs	48" wide / 157 lbs
78" wide / 230 lbs	42" wide / 141 lbs
72" wide / 215 lbs	36" wide / 114 lbs
66" wide / 199 lbs	30" wide / 99 lbs

Instructions cover some of typical product layouts:

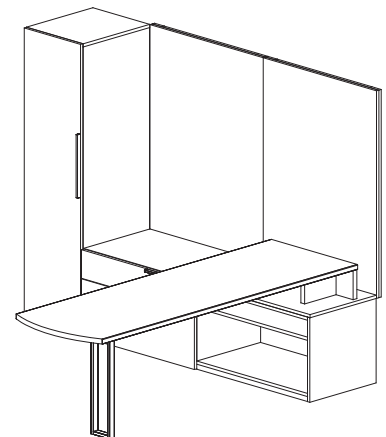
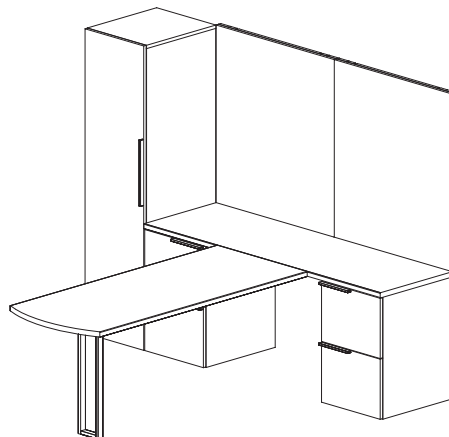
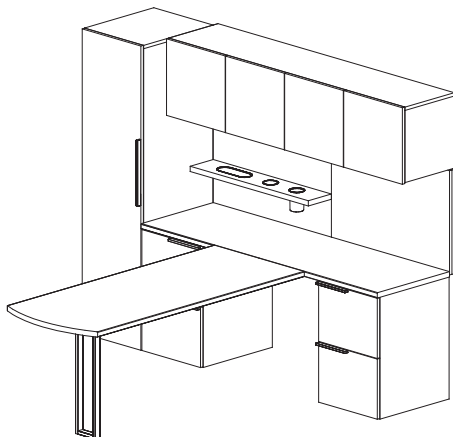

Notice To Installers: Failure to comply with installation instructions will compromise the safety, durability and performance of this product, which may risk injury to the user of this product and/or diminish the product life cycle. Jasper Group assumes no liability in these instances.

Wall Mounting Storage and Wall Panels *continued*

Attaching the Wall Hanger to the Building Walls

Note:

1. All measurements are from the bottom of the wall cleat illustrated in grey.
2. Make sure all horizontal measurements are level either with a standard level or a digital laser level.
3. Check for high points in the floor.
4. See next page for additional diagrams and tips.

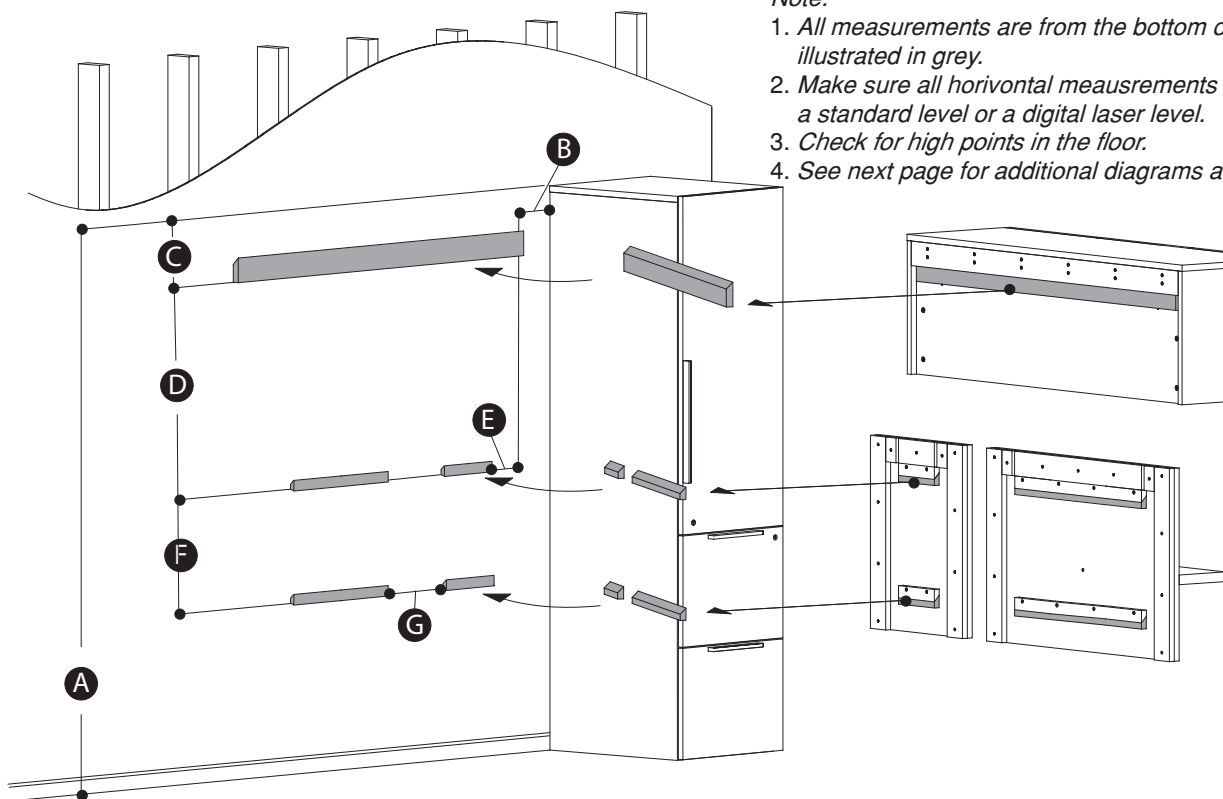

Step 1

Attaching the Wall Hangers

- Unpack wall hanging components, do not remove the wall hanger.
- **Measurement A**
Establish the overall landscape height.
- 81" or 69" are the two heights in Flux
- if there is a wardrobe style cabinet place and level that unit first.
- **Measurement B**
Establish the first vertical measurement by measuring up the wall hanging cabinet as indicated in the diagram to the right then mark the wall.
- **Measurement C**
Establish the first horizontal measurement by measuring to the wall hanging cabinet as indicated in the diagram to the right then mark the wall.
- Repeat if needed, measure for **D, E, F, G**, for additional wall hanging components.
- Identify the proper method for installing the wall hanger to the wall. Remove the wall hanger from the cabinet and pre-bore the wall hangers, if needed.
- Fasten the wall hanger to the wall in the proper position.

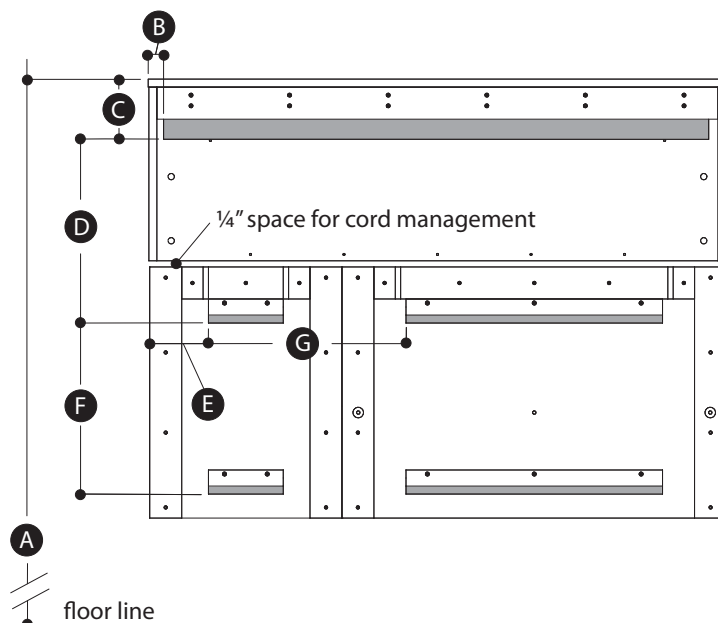

Notice To Installers: Failure to comply with installation instructions will compromise the safety, durability and performance of this product, which may risk injury to the user of this product and/or diminish the product life cycle. Jasper Group assumes no liability in these instances.

Wall Mounting Storage and Wall Panels *continued*

Step 2

Hanging the Components

- Start with wall boards first then attach wall cabinets.
- Lift, position and place the wall board(s) as indicated onto the wall hanger per the plan.
- Lift, position and place the wall cabinet(s) as indicated the wall hanger per the plan.

Note: *Optional tasklights should be attached prior to hanging the components for proper wire management.*

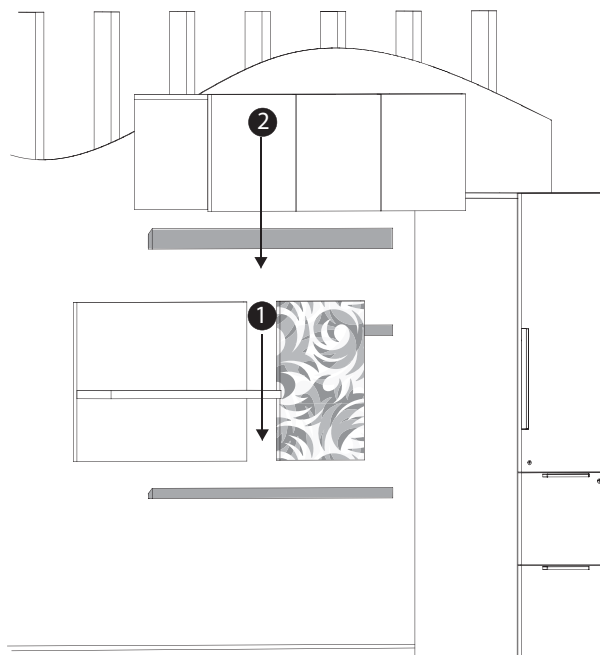

Additional Information

Double High Storage Cabinet

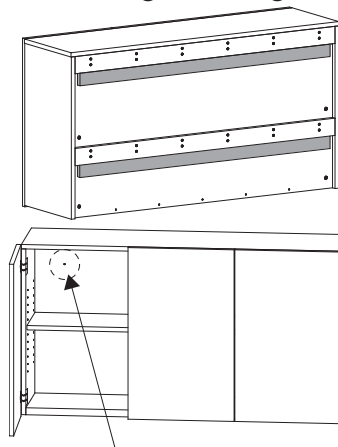

two wall hangers per cabinet.

requires a safety attachment to prevent accidental cabinet lift, use the #8 pan head screws (included with the double high cabinets) to fasten through the inside back to catch the wall hanger

Task Light Wiring

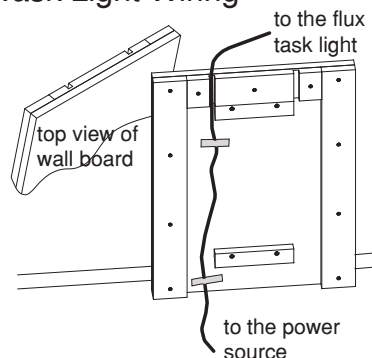

a slot at the top of the wall board allows for the Flux task light wiring to run behind the wall board, it is recommended to use tape (loosely attached) to hold the cord in place during installation

*** Important Information

must maintain these two dimensions to assure proper stack-up

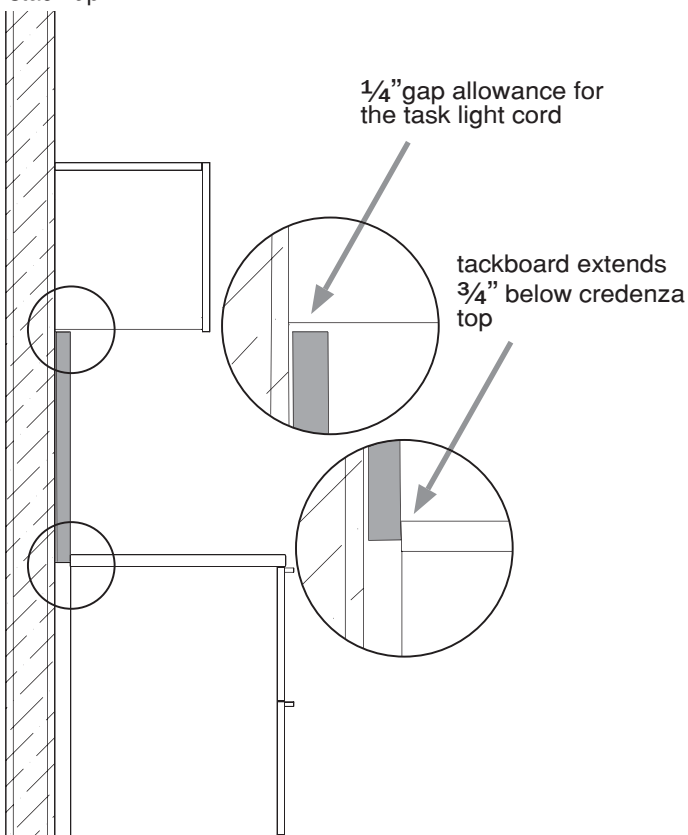

Notice To Installers: Failure to comply with installation instructions will compromise the safety, durability and performance of this product, which may risk injury to the user of this product and/or diminish the product life cycle. Jasper Group assumes no liability in these instances.



JASPER
GROUP
BRAND

jsifurniture.com
800.457.4511

812.482.3204 O
812.482.1548 F

225 Clay Street / PO Box 231
Jasper, Indiana 47546

Form No. INST-FL008
12/15/17